

DWG. NO. 221-010-00406G

REV	DESCRIPTION	BY DATE	APPD
A	RELEASED PER ECR 7435	08/13/02 KJT	08/13/02 KJT

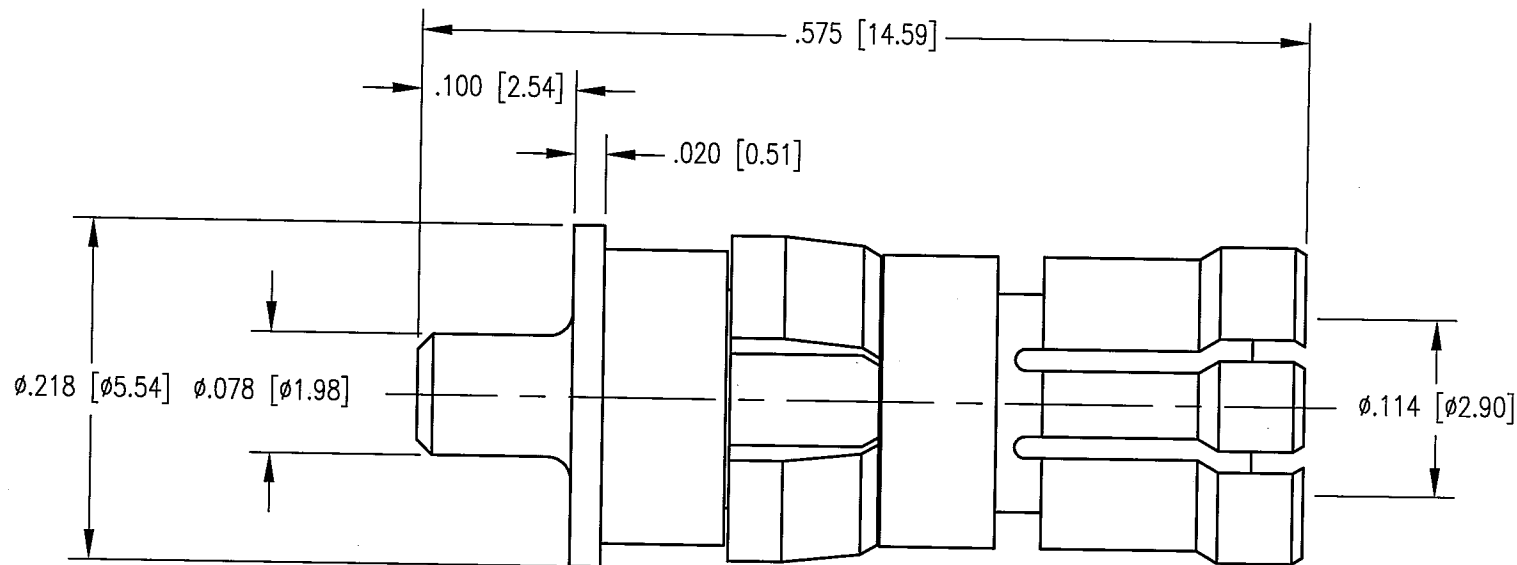

NOTES:

1. MATERIALS:
 BODY: COPPER ALLOY
 CLIP RING: BERYLLIUM COPPER PER ASTM B194
2. FINISH:
 BODY: .000030 MIN. GOLD PER MIL-G-45204 OVER
 .000050 MIN. NICKEL PER QQ-N-290
 CLIP RING: .000100 MIN. NICKEL PER QQ-N-290 OVER
 COPPER FLASH

PER ASME Y14.5M-1994 UNLESS OTHERWISE SPECIFIED: DIMENSIONS ARE IN INCHES [MM]		NORTHROP GRUMMAN	
TOLERANCES: DECIMALS .XX ± .01 [0.254] .XXX ± .005 [0.127]		Winchester Electronics 400 Park Road Watertown, CT 06795	
ANGLES ± 2° SCALE: 8:1		TITLE FIRST MATE/LAST BREAK 20 AMP POWER RECEPTACLE	
CUSTOMER DRAWING			
DRAWN KJT	DATE 08/13/02	CHECKED [Signature]	DATE 8/15/02
APPROVED [Signature]	DATE 8/14/02	APPROVED [Signature]	DATE 8/15/02
A 221-010-00406G		SHT. OF 1 1	REV. A